

Innovation

Short Report

INN-2 EXCEEDING GREEN STAR BENCHMARKS

Please ensure all prompts shown in **Blue text** have been responded to.

Green Star – **Interiors Built 2009**

Project Name: **NZGBC Office Fitout**

Points available: 5

Points claimed: **1**

1. Exceeding Green Star benchmarks in credits

1.1 Initiative 1: **IEQ-C Indoor Plants**

The project team has achieved the maximum available points outlined within the credit criteria, further exceeding the Green Star benchmarks as outlined and further described below.

1.2. How have the initiatives exceeded benchmarks in the Green Star NZ Tool that the project is registered under?

With a total NLA of 257m², a minimum equivalent of 9 x 150mm diameter pot equivalents are required to be awarded the first point outlined in IEQ-C Indoor Plants. To achieve the second point, a minimum of 17 x 150mm diameter pot equivalents are required to achieve the highest benchmark awarding two points.

At NZGBC, a staggering 73 pot plant equivalents are evenly distributed throughout the workplace and common areas. This means that NZGBC provide more than four times the required number of plants, i.e. an average of 4.8 plants for every 15m² of the NLA. Evidently, this exceeds the highest Green Star benchmarks by a significant margin.

In addition, whilst feature planting in common areas is acceptable, the Technical Manual states that this must not account for more than 20% of all plants provided. At the NZGBC offices, only 9.3% of all plants are located in common areas. This is less than half of the percentage allowed.

1.3 What is the measurable environmental benefit of the innovation?

With numerous synthetic materials incorporated in today's buildings, large mixtures of toxins are released at all times in the confines of a closed interior. This build up can become significant enough to affect the wellbeing of its occupants.

At NZGBC, by distributing a range of suitably selected indoor plant varieties that are with low-allergy and high air-purifying qualities, the need for chemicals and energy use during the air purifying process are removed, and additional health benefits within the workplace are raised considerably.

According to research carried out by the University of Queensland, an office enriched with plants makes staff happier and boosts productivity by 15% creating a more enjoyable, comfortable and profitable

place to work. This is for a number of reasons including that fact that indoor plants provide an excellent connection to nature, creating those positive feelings that people get when surrounded by living systems, they improve productivity and stress recovery, increase patience and overall workplace satisfaction.¹

1.4 Supporting Documentation

All documentation to support this claim is provided as part of the Green Star credit submission for that credit, consisting of:

- *NZGBC_Plant_Location.pdf*
- *IEQ-C_Maintenance.pdf*
- *IEQ-C_Built.pdf*

Therefore, as demonstrated in section 1, this project is eligible to achieve 1 point(s) for achieving environmental benefits in excess of the current Green Star benchmarks.

Author Details:

NinaMay Gill

5/03/2015

— **Report end** —

(The report is to be on the letterhead of the company preparing the report)

Date issued: 7 January 2015 (pre-release)

¹ <http://www.businessinsider.com.au/heres-why-putting-plants-in-your-office-will-improve-productivity-and-the-bottom-line-2015-3>

NOTES:
1. Existing building survey provided by owner, we accept no liability for the accuracy of the survey / boundary information contained on the drawings.

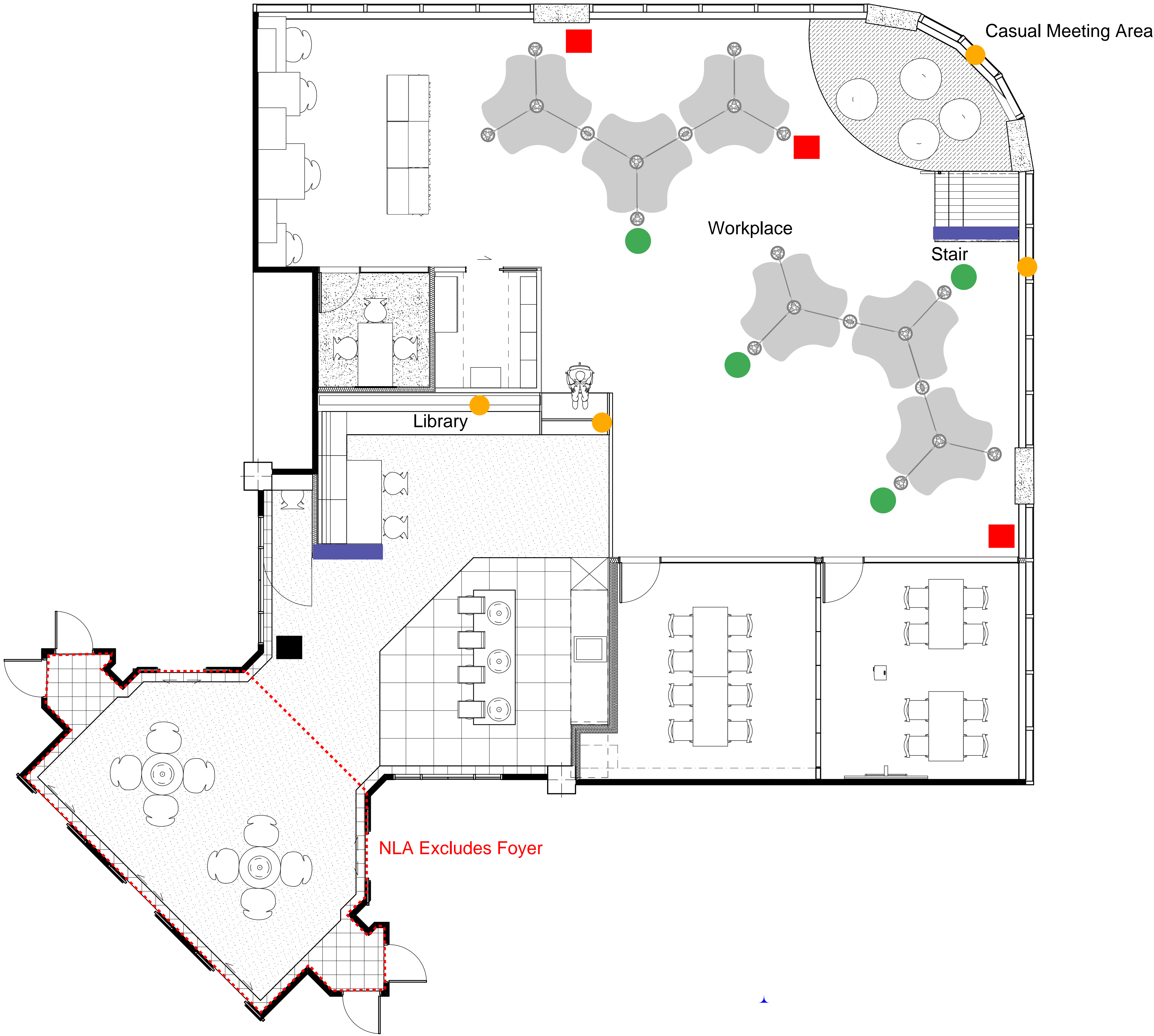

Round Pots

● Workplace = 4

Square Pots

■ Workplace = 3

■ Stair / Library Troughs = 2

● Small Pots = 4

■ Entry = 1

NLA Excludes Foyer

PHIL SMITH, ARCHITECTS (UK) LTD

28 SPENCER STREET
REMUEA
AUCKLAND
NEW ZEALAND

T: 09 529 0403

M: 021 716 893

E: phil@philsmith.co.nz

REVISIONS DATE
07/01/15 - Rev A - As Built

JOB TITLE
**Proposed office fitout for
NZGBC
205 Queen St, Auckland.**

DRAWING TITLE
Furniture Layout

ISSUE DATE
Cons Aug 2014

DRAWN SCALE CHECKED
ps/gc 1:50@ A1 DOUBLE @ A3 ps

JOB NO. SHEET REVISION
P-0135 106 A

The contractor shall check and verify all dimensions, levels and angles on site prior to commencing any work. The copyright of these drawings and all parts thereof remain the property of PHIL SMITH ARCHITECTS (UK) LTD. Dimensions must not be scaled from the drawings.

Quote

NZ Green Building Council
P O Box 5286
Wellesley Street

Auckland 1141

Quote No.: 00003648
Date: 01/01/2015



EXOTIC PLANTERS .co.nz

creating healthy interior plantscapes

P O Box 5562, Wellesley Street, Auckland 1141, Ph: 09 360 1206 Fax: 09 360 1207 Email: sales@exoticplanters.co.nz

Hi Clare & Susan

NEW PREMISES - Level 2, Tower 1, 205 Queen Street

The cost to maintain all the indoor plant specimens, trough plants and table-top plants on your level will cost as follows:

2 x Philodendron vines & liners, staging, dressing (EP delivered & installed for custom built troughs)

1 x Dracaena marginata specimen (new EP replacement plant)

An ongoing plant maintenance service (fortnightly) which involves watering, feeding, polishing and bug control for all the above plants and existing plant specimens relocated from previous premises the cost will be [REDACTED] plus GST per annum.

\$ [REDACTED]

This agreement will be for a minimum period of 1 year commencing 1/1/15 - 31/12/15

We have been more than happy maintaining the plants for NZGBC and we continue to be supportive of your vision in promoting green buildings / office spaces.

Kind regards

Robert Ferguson

SUB - TOTAL: \$ [REDACTED]

GST: \$ [REDACTED]

GST Reg. Number: 52-020-654

TOTAL: \$ [REDACTED]

Quote Acceptance
PLEASE RETURN THIS PORTION SIGNED

EXOTIC PLANTERS LTD
P O Box 5562
Wellesley Street
Auckland 1141

Quote No: 00003648

Sign and